

Recessed Lighting

3" Low Voltage Housings

HL300R

Job Name	_____
Date	_____
Type	_____
Location	_____
Comments	_____

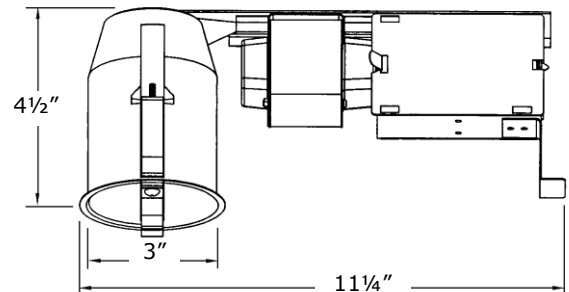

Product Specifications

Description:	Remodel post drywall housing
Dimensions:	11 1/4" Length by 4 1/2" Height
Lamp:	1 x 50W 12V MR16 Max
Listings:	UL damp location with feed through wiring

Housing Features

- Unit slips through 3 1/8" ceiling opening
- For use in non-insulated ceilings or 3" space between housing and insulation
- Two durable screw-down clips secure housing and accommodate various ceiling thickness
- Integral Magnetic Class H thermally protected transformer steps down 120V line voltage to lamp operating voltage
- Junction box is listed for through branch circuit wiring and has seven 1/2" knockouts
- Four Romex pry-outs with strain relief simplify Romex installation
- 4-port quick connector pre-installed in j/box

